



### Ozuapd-Air

It works as a full-functioned mouse, Presentation mouse remote or even a Joystick if you happen to need one.

**Thumb-operated, Palm-held  
Accurate & Smooth**



**[Set up]** .....could be completed in about 10 seconds

Establish wireless connection between computer and OZUPAD-Air  
OZUPAD-Air and PC are connected with a wireless USB transceiver.  
*There will be no interference between the OZUPAD-Air and other wireless devices, such as mice and keyboards, when the connection between the OZUPAD-Air and your computer is established once.*



#### ➤ Procedure to connect the OZUPAD-Air for the **first time (pairing)**

1. Confirm that there are two AAA batteries in OZUPAD-Air.
2. Turn on the computer.
3. Insert the USB wireless transceiver into the USB port in your computer, and wait for the computer to recognize this USB transceiver. This procedure usually takes less than 10 seconds.
4. Bring the OZUPAD-Air to **within 1 inch** of the USB wireless receiver, turn the Ozupad-Air on by switching <Switch 1> located on the right hand side of the Ozupad-Air, to the position "I", and hold down <button 2>. When the connection is completed, the <LED> light flashes red and then turn into blue color.
5. The OZUPAD-Air now is ready to fly.

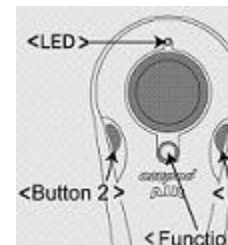

#### ➤ Release of the pairing and procedure for re-pairing

After the pairing has been completed, the pairing with the USB wireless receiver cannot be released; unless completing a pairing with another USB receiver as procedure above, then the data from previous pairing will be erased.

#### ➤ Use of two or more Ozupad-Air

Up to five OZUPAD-Airs can be simultaneously connected with one USB wireless receiver. When you try to pair another Ozupad-Air with the USB receiver, the previous paired Ozupad-Air must be at least 2 feet apart from the new Ozupad-Air until the new procedure has been completed.

- Switching the <Switch 1> to “1” to turn on the device, to “0” to turn off the device.
- Toggle <Function Button> to change the function mode and the corresponding indication color of the <LED> light. Light will be off about 10 seconds for power saving if the device is not operated; touch any button, the current color (status) will be shown and the device resumes operation.

**Switching <Switch 2> to “1” as to upper position & <LED> color BLUE**

**>> Mouse function**

Using your thumb to operate the <Vector Pad> as cursor control in a mouse; pressed firmly, the cursor moves quickly. <Button 1> & <Button 4> acting as a left-click, and <Button 3> acting as right-click in a mouse.

To “**Scroll**”, press <Button 2>, the color of <LED> will be changed to color **RED**, the <Vector Pad> will act for “Scrolling” as in a mouse. Press the <Button 2> again and the color of <LED> light will turn **BLUE**, the <Vector Pad> acts as “cursor control” again.

<Function Button> The mouse and joystick functions can be toggled using this button; and the colors of the <LED> light indicate the function modes (status) of the Ozupad Air:

- Blue** = Mouse and Presentation mouse function
- Red** = Scroll function (as in the Mouse function)
- Violet** = Joystick Function

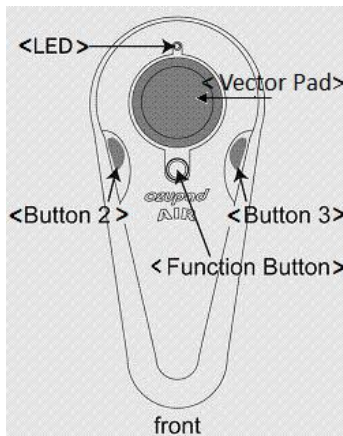

<Switch 1> – “1” power-on, “0” power-off

<Switch 2> – When <LED> colored **BLUE**

“1” = Mouse Mode,

“2” = Presentation Mouse Function Mode

<Vector Pad> – A 360 degree highly pressure-sensitive cursor control.

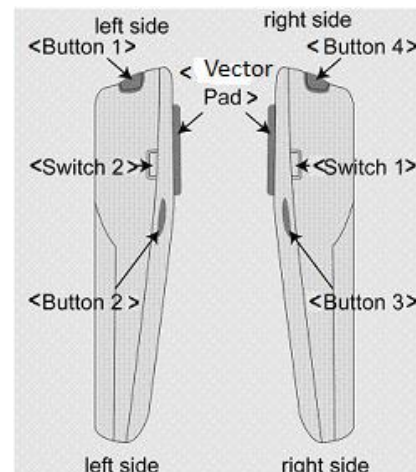

**Switching <Switch 2> to “2” as to lower position & <LED> color BLUE**

**>> Presentation function** (note: vector pad and scroll feature also work as Mouse function does)

When using PowerPoint\*, press <Button 3> for PgUp or <Button 2> for PgDn. <Button 4> acts as a left-click in a mouse, and press <Button 1>, the **Highlight** function to “focus” on the location that cursor is on the screen. (No Laser light used to avoid possibly dangerous to human eyes).

The Focus/Highlight function can be activated **by** checking the box of “Show location of pointer when I press the CTRL key” located at [Start Menu => Control Panel => Hardware and Sound => Mouse => Pointer Options] in the MS Windows\* (the function only works in the Windows); **or see next page.**

[www.TekiStore.com](http://www.TekiStore.com)

**Another feature – Joystick/jog and with a free software, you may program it to fit your very own application**

toggling <Function Button> until the light of the <LED> turned to color **VIOLET**. It is now on the **Joystick function. It could now be used to fit your own applications needs.** You may assign keys (functions) to the buttons on the device as you want; and the unique Vector pad will bring you robust and smooth of joystick control that could possibly meet the maximum requirement of your applications. The application software **OZUPADLEY** allows the device to work like a multimedia controller. If you would like to use this feature, the software is free and available to be downloaded at <http://www.ozupad.com/download.html> or visit [www.TekiStore.com](http://www.TekiStore.com) It could then also work as a multimedia controller. (Version 11 or higher of Media Player is required)

❖ **Safety pointer for the presentation**

LASER Pointer is no longer necessary if you use a **highlight circle** feature along with Ozupad-Air. Laser Ray could cause damage to the humans' eyes, especially students in the class room. You will be able to give your presentations more impact by highlighting vital information on the screen.

Please download the free software “Ozupad Air highlight set up” from <http://www.ozupad.com/download.html>

The software application could be used when USB receiver of OZUPAD-AIR connected to your computer. You'll then be able to use the **highlight circle** or **highlight bar** feature shown as below.

Example 1

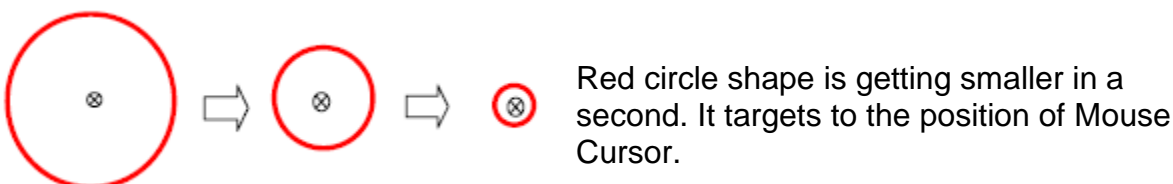

Example 2  The Red bar shows your target position. Hold the <Button 1>, the red bar (line) will be continued showing until un-holding the <Button 1>.

You can use one of the highlight marks (see next page) when <Switch 2> is switched to the position 2 (Presentation mode).

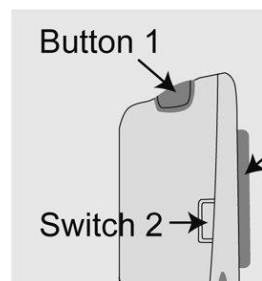
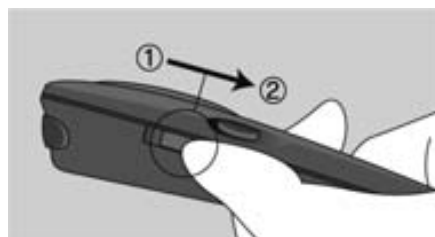

You will see the highlight circle or red bar appearing when <Button 1> is pressed.

Note: This function can be used with focus function simultaneously that Windows provided.

## Highligh Mark Selections:

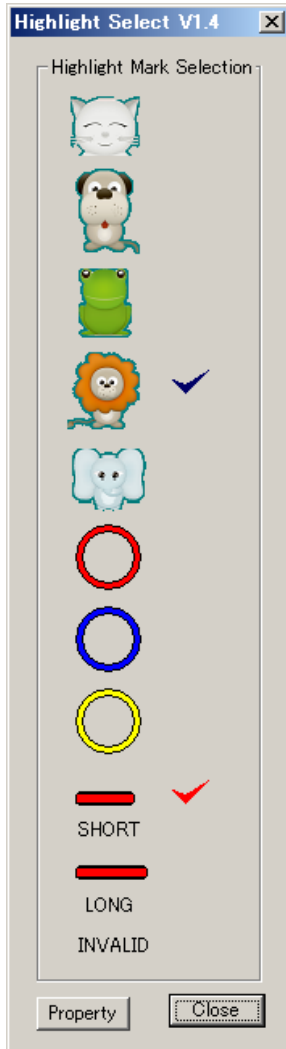

After insatalling the “highlight\_setup” utility, the Ozupad-Air icon will be shown at the bottom of your display (Windows) and it indiactes that the OZUPAD-AIR Utility is ready to be used.



Make sure the <Switch 2> at the position 1 (Mouse mode) and press <Button 2> on the icon, the “Highlight Mark Selection” will be shown up. Select the mark you prefer and press the <Button 2>, then “Close” the selection. You have complete the selection and have a mark that you may use, for presentation. You can always go back to select another mark when needed.

You may switch the <Switch 2> at the position 2 to the Presentaion Mode when doing presentation.

Note: <Switch 2> is on the left-hand side of the Ozupad-Air; it is used for switching between Mouse mode and Presentation mode. <Switch 1> is on the right-hand side of the Ozupad-Air; it is used for switching Power On and Off.